

Universal Structural Bracket, Strut Brace

Data Solutions



CERTIFICATIONS



FEATURES

Used for installations where strut brace is perpendicular to structure

One wrench size fits all required hardware, eliminating the need to change tools

Shear-off head helps ensure correct torque and simplifies inspection

SPECIFICATIONS

Finish: Electrogalvanized

Material: Steel

Table 1/2

Catalog Number	Article Number	Hole Size (HS)	Width (W)	Thickness (T)	A	B
CSBUS1	404568	14.3mm	40.6mm	6.4mm	133.4mm	12.7mm
CSBUS2	404569	20.6mm	40.6mm	6.4mm	133.4mm	12.7mm

Table 2/2

Catalog Number	Article Number	C	D	E
CSBUS1	404568	40.6mm	50.8mm	66mm
CSBUS2	404569	40.6mm	50.8mm	66mm

ADDITIONAL PRODUCT DETAILS

Cut length for strut member is +/- 1" (25 mm) of measured length.

FM Loads					
Part Number	Brace Member	Horizontal Capacity per Installation Angle from Vertical			
		30° - 44°	45° - 59°	60° - 74°	75° - 90°
CSBUS1	41 x 41 Strut Channel	8940 N	12630 N	15210 N	16940 N
CSBUS2	41 x 41 Strut Channel	8940 N	12630 N	15210 N	16940 N

DIAGRAMS

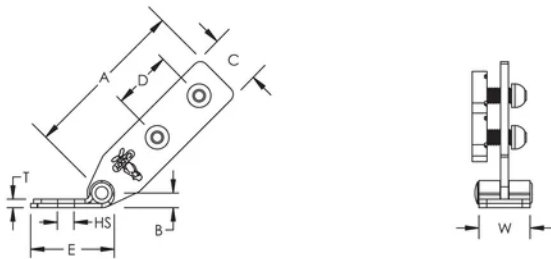

WARNING

nVent products shall be installed and used only as indicated in nVent's product instruction sheets and training materials. Instruction sheets are available at www.nvent.com and from your nVent customer service representative. Improper installation, misuse, misapplication or other failure to completely follow nVent's instructions and warnings may cause product malfunction, property damage, serious bodily injury and death and/or void your warranty.



Our powerful portfolio of brands:

CADDY ERICO HOFFMAN ILSCO SCHROFF TRACHTE