

455 Malleable Split Ring Hanger



FEATURES

Recommended for the suspension of stationary non-insulated pipe lines

Allows for piping runs close to ceiling or walls

Conforms with Federal Specification WW-H-171 (Type 25), Manufacturers Standardization Society (MSS) SP-58 (Type 12)

SPECIFICATIONS

Material: Cast Iron

Table 1/1

Catalog Number	Finish	Outer Diameter (OD)	A	B	Static Load
4550075PL	Plain	26.7 mm	44.45 mm	11.11 mm	800N
4550050PL	Plain	21.3 mm	38.1 mm	9.53 mm	800N
4550100PL	Plain	33.4 mm	50.8 mm	11.11 mm	800N
4550150EG	Electrogalvanized	48.3 mm	66.67 mm	12.7 mm	800N
4550075EG	Electrogalvanized	26.7 mm	44.45 mm	11.11 mm	800N
4550200PL	Plain	60.3 mm	79.38 mm	12.7 mm	800N
4550150PL	Plain	48.3 mm	66.67 mm	12.7 mm	800N
4550125PL	Plain	42.2 mm	60.33 mm	12.7 mm	800N
4550050EG	Electrogalvanized	21.3 mm	38.1 mm	9.53 mm	800N
4550200EG	Electrogalvanized	60.3 mm	79.38 mm	12.7 mm	800N
4550100EG	Electrogalvanized	33.4 mm	50.8 mm	11.11 mm	800N

Catalog Number	Finish	Outer Diameter (OD)	A	B	Static Load
4550125EG	Electrogalvanized	42.2 mm	60.33 mm	12.7 mm	800N
4550400EG	Electrogalvanized	114.3 mm	136.53 mm	17.46 mm	1334N
4550250PL	Plain	73 mm	82.55 mm	15.88 mm	1334N
4550400PL	Plain	114.3 mm	136.53 mm	17.46 mm	1334N
4550300EG	Electrogalvanized	88.9 mm	111.12 mm	15.88 mm	1334N
4550300PL	Plain	88.9 mm	111.12 mm	15.88 mm	1334N
4550250EG	Electrogalvanized	73 mm	82.55 mm	15.88 mm	1334N

ADDITIONAL PRODUCT DETAILS

Bolt and rivet are carbon steel.

DIAGRAMS

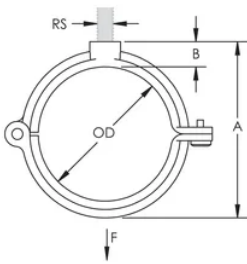

WARNING

nVent products shall be installed and used only as indicated in nVent's product instruction sheets and training materials. Instruction sheets are available at www.nvent.com and from your nVent customer service representative. Improper installation, misuse, misapplication or other failure to completely follow nVent's instructions and warnings may cause product malfunction, property damage, serious bodily injury and death and/or void your warranty.

North America

+1.800.753.9221

Option 1 – Customer Care

Option 2 – Technical

Support

Europe

Netherlands:

+31 800-0200135

France:

+33 800 901 793

Europe

Germany:

800 1890272

Other Countries:

+31 13 5835404

APAC

Shanghai:

+ 86 21 2412 1618/19

Sydney:

+61 2 9751 8500



Our powerful portfolio of brands:

CADDY ERICO HOFFMAN ILSCO SCHROFF TRACHTE

