

Compression Straight Lug

Data Solutions



FEATURES

Tin plated for corrosion prevention

Annealed copper eases the crimping operation

Optimized sizes to the most efficient electrical conductivity

Best mechanical behavior (vibration/pull-out); DIN EN 61373 Class 1B "Railway Applications"

Markings on barrel for crimping

Consistent material thickness, precise diameter and accurate cable fit; DIN46235

SPECIFICATIONS

Material: Copper

Finish: Tinned

Table 1/2

Catalog Number	Lug/Connector Type	Conductor Size	Hole Size (HS)	Length (L)	Width (W)	Tool/Die Type
PKS5010H	Heavy-Duty DIN46235	1/0 Stranded, 50 mm ² Stranded	10.5mm	65mm	21mm	M2M or M2H/PKM2, M3H or M3B/PKM3, MLB/PKML

Catalog Number	Lug/Connector Type	Conductor Size	Hole Size (HS)	Length (L)	Width (W)	Tool/Die Type
RKS1612T	Standard	#5 Stranded, 16 mm ² Stranded	13mm	45mm	19mm	M2M or M2H/RKM2, M3H or M3B/RKM3, MLB/RKML
RKS612T	Standard	6 mm ² Stranded	13mm	41mm	19mm	M2M or M2H/RKM2, MLB/RKML
PKS18512H	Heavy-Duty DIN46235	185 mm ² Stranded, 350 kcmil Stranded	13mm	98mm	37mm	M2M or M2H/PKM2, M3H or M3B/PKM3, MLB/PKML
RKS24012H	Standard	240 mm ² Stranded, 500 kcmil Stranded	13mm	83mm	39mm	M2M or M2H/RKM2, M3H or M3B/RKM3, MLB/RKML
RKS15012T	Standard	150 mm ² Stranded, 300 kcmil Stranded	13mm	72mm	31mm	M2M or M2H/RKM2, M3H or M3B/RKM3, MLB/RKML
RKS7012T	Standard	2/0 Stranded, 70 mm ² Stranded	13mm	59mm	23mm	M2M or M2H/RKM2, M3H or M3B/RKM3, MLB/RKML
RKS050019H	Standard	300 mm ² Stranded, 600 kcmil Stranded	13mm	109mm	43mm	M2M or M2H/RKM2, M3H or M3B/RKM3
RKS9512T	Standard	4/0 Stranded, 95 mm ² Stranded	13mm	62mm	26mm	M2M or M2H/RKM2, M3H or M3B/RKM3, MLB/RKML
RKS12012H	Standard	120 mm ² Stranded, 250 kcmil Stranded	13mm	65mm	28mm	M2M or M2H/RKM2, M3H or M3B/RKM3, MLB/RKML

Catalog Number	Lug/Connector Type	Conductor Size	Hole Size (HS)	Length (L)	Width (W)	Tool/Die Type
PKS1612H	Heavy-Duty DIN46235	#5 Stranded, 16 mm ² Stranded	13mm	49mm	18mm	M2M or M2H/PKM2, M3H or M3B/PKM3, MLB/PKML
RKS2512T	Standard	#3 Stranded, 25 mm ² Stranded	13mm	48mm	19mm	M2M or M2H/RKM2, M3H or M3B/RKM3, MLB/RKML
PKS24012H	Heavy-Duty DIN46235	240 mm ² Stranded, 500 kcmil Stranded	13mm	108mm	42mm	M2M or M2H/PKM2, M3H or M3B/PKM3
RKS18512T	Standard	185 mm ² Stranded, 350 kcmil Stranded	13mm	83mm	35mm	M2M or M2H/RKM2, M3H or M3B/RKM3, MLB/RKML
RKS3512T	Standard	#2 Stranded, 35 mm ² Stranded	13mm	51mm	21mm	M2M or M2H/RKM2, M3H or M3B/RKM3, MLB/RKML
PKS24016H	Heavy-Duty DIN46235	240 mm ² Stranded, 500 kcmil Stranded	15mm	111mm	42mm	M2M or M2H/PKM2, M3H or M3B/PKM3
PKS15016H	Heavy-Duty DIN46235	150 mm ² Stranded, 300 kcmil Stranded	15mm	97mm	34mm	M2M or M2H/PKM2, M3H or M3B/PKM3, MLB/PKML
PKS40020H	Heavy-Duty DIN46235	400 mm ² Stranded, 800 kcmil Stranded	15mm	140mm	54mm	M4FP/PKM4, MLB
PKS18516H	Heavy-Duty DIN46235	185 mm ² Stranded, 350 kcmil Stranded	15mm	101mm	37mm	M2M or M2H/PKM2, M3H or M3B/PKM3, MLB/PKML
PKS30020H	Heavy-Duty DIN46235	300 mm ² Stranded, 600 kcmil Stranded	15mm	119mm	46mm	M2M or M2H/PKM2, M3H or M3B/PKM3

Table 2/2

Catalog Number	Lug/Connector Type	Conductor Size	Hole Size (HS)	Length (L)	Width (W)	Tool/Die Type
PKS12014H	Heavy-Duty DIN46235	120 mm ² Stranded, 250 kcmil Stranded	15mm	88mm	32mm	M2M or M2H/PKM2, M3H or M3B/PKM3, MLB/PKML
RKS30016T	Standard	300 mm ² Stranded, 600 kcmil Stranded	17mm	101mm	43mm	M2M or M2H/RKM2, M3H or M3B/RKM3
RKS24016T	Standard	240 mm ² Stranded, 500 kcmil Stranded	17mm	93mm	39mm	M2M or M2H/RKM2, M3H or M3B/RKM3, MLB/RKML
PKS40016H	Heavy-Duty DIN46235	400 mm ² Stranded, 800 kcmil Stranded	17mm	140mm	54mm	M4FP/PKM4
RKS9516T	Standard	4/0 Stranded, 95 mm ² Stranded	17mm	66mm	26mm	M2M or M2H/RKM2, M3H or M3B/RKM3, MLB/RKML
PKS30016H	Heavy-Duty DIN46235	300 mm ² Stranded, 600 kcmil Stranded	17mm	119mm	46mm	M2M or M2H/PKM2, M3H or M3B/PKM3
RKS12016T	Standard	120 mm ² Stranded, 250 kcmil Stranded	17mm	67mm	28mm	M2M or M2H/RKM2, M3H or M3B/RKM3, MLB/RKML
RKS40016T	Standard	400 mm ² Stranded, 800 kcmil Stranded	17mm	114mm	49mm	M3H or M3B/RKM3
RKS15016T	Standard	150 mm ² Stranded, 300 kcmil Stranded	17mm	72mm	31mm	M2M or M2H/RKM2, M3H or M3B/RKM3, MLB/RKML
RKS18516T	Standard	185 mm ² Stranded, 350 kcmil Stranded	17mm	83mm	35mm	M2M or M2H/RKM2, M3H or M3B/RKM3, MLB/RKML

DIAGRAMS

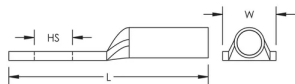

WARNING

nVent products shall be installed and used only as indicated in nVent's product instruction sheets and training materials. Instruction sheets are available at www.nvent.com and from your nVent customer service representative. Improper installation, misuse, misapplication or other failure to completely follow nVent's instructions and warnings may cause product malfunction, property damage, serious bodily injury and death and/or void your warranty.



Our powerful portfolio of brands:

CADDY ERICO HOFFMAN ILSCO SCHROFF TRACHTE