

U-Bolt

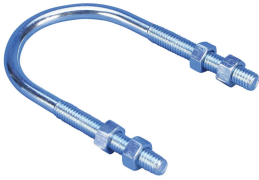

FEATURES

Complete with 4 nuts

SPECIFICATIONS

Table 1/3

| Catalog Number | Article Number | Material | Finish | Outer Diameter (OD) | NB/DN | Rod Size (RS) |
|----------------|----------------|---------------------------------|-------------------|---------------------|-------|---------------|
| UB4N23M6S6 | 599485 | Stainless Steel 316 (EN 1.4401) | | 23 mm | 10 | M6 |
| UB4N30M6EG | 599405 | Steel | Electrogalvanized | 30 mm | 20 | M6 |
| UB4N027M8S6 | 597615 | Stainless Steel 316 (EN 1.4401) | | 27 mm | 20 | M8 |
| UB4N30M6S6 | 599490 | Stainless Steel 316 (EN 1.4401) | | 30 mm | 20 | M6 |
| UB4N36M8S6 | 599495 | Stainless Steel 316 (EN 1.4401) | | 36 mm | 25 | M8 |
| UB4N36M8EG | 599410 | Steel | Electrogalvanized | 36 mm | 25 | M8 |
| UB4N46M6EG | 599415 | Steel | Electrogalvanized | 42 mm | 32 | M8 |

| Catalog Number | Article Number | Material | Finish | Outer Diameter (OD) | NB/DN | Rod Size (RS) |
|----------------|----------------|---------------------------------|-------------------|---------------------|-------|---------------|
| UB4N042M8 | 599150 | Steel | Electrogalvanized | 42 mm | 32 | M8 |
| UB4N46M6S6 | 599510 | Stainless Steel 316 (EN 1.4401) | | 46 mm | 32 | M6 |
| UB4N049M8S6 | 597645 | Stainless Steel 316 (EN 1.4401) | | 49 mm | 40 | M8 |
| UB4N049M8 | 599160 | Steel | Electrogalvanized | 49 mm | 40 | M8 |
| UB4N52M8S6 | 599515 | Stainless Steel 316 (EN 1.4401) | | 52 mm | 40 | M8 |
| UB4N52M8EG | 599420 | Steel | Electrogalvanized | 49 mm | 40 | M8 |
| UB4N042M8S6 | 597635 | Stainless Steel 316 (EN 1.4401) | | 42 mm | 32 | M8 |
| UB4N64M8EG | 599425 | Steel | Electrogalvanized | 60 mm | 50 | M8 |
| UB4N64M8S6 | 599520 | Stainless Steel 316 (EN 1.4401) | | 65 mm | 50 | M8 |
| UB4N74M8EG | 599430 | Steel | Electrogalvanized | 74 mm | 65 | M8 |
| UB4N74M8S6 | 599525 | Stainless Steel 316 (EN 1.4401) | | 74 mm | 65 | M8 |
| UB4N076M8S6 | 597665 | Stainless Steel 316 (EN 1.4401) | | 76 mm | 65 | M8 |
| UB4N94M10EG | 599440 | Steel | Electrogalvanized | 94 mm | 80 | M10 |

Table 2/3

| Catalog Number | Article Number | Material | Finish | Outer Diameter (OD) | NB/DN | Rod Size (RS) |
|----------------|----------------|---------------------------------|-------------------|---------------------|-------|---------------|
| UB4N090M10 | 599190 | Steel | Electrogalvanized | 90 mm | 80 | M10 |
| UB4N94M10S6 | 599530 | Stainless Steel 316 (EN 1.4401) | | 94 mm | 80 | M10 |

| Catalog Number | Article Number | Material | Finish | Outer Diameter (OD) | NB/DN | Rod Size (RS) |
|----------------|----------------|---------------------------------|-------------------|---------------------|-------|---------------|
| UB4N118M10EG | 599445 | Steel | Electrogalvanized | 118 mm | 100 | M10 |
| UB4N118M10S6 | 599535 | Stainless Steel 316 (EN 1.4401) | | 118 mm | 100 | M10 |
| UB4N114M10 | 599200 | Steel | Electrogalvanized | 114 mm | 100 | M10 |
| UB4N114M8S6 | 599348 | Stainless Steel 316 (EN 1.4401) | | 114 mm | 100 | M8 |
| UB4N146M12S6 | 599540 | Stainless Steel 316 (EN 1.4401) | | 146 mm | 125 | M12 |
| UB4N146M12EG | 599450 | Steel | Electrogalvanized | 146 mm | 125 | M12 |
| UB4N140M8S6 | 599350 | Stainless Steel 316 (EN 1.4401) | | 140 mm | 125 | M8 |
| UB4N140M8 | 599337 | Steel | Electrogalvanized | 140 mm | 125 | M8 |
| UB4N168M12EG | 599455 | Steel | Electrogalvanized | 168 mm | | M12 |
| UB4N168M12S6 | 599545 | Stainless Steel 316 (EN 1.4401) | | 168 mm | | M12 |
| UB4N160M8S6 | 599351 | Stainless Steel 316 (EN 1.4401) | | 160 mm | | M8 |
| UB4N160M8 | 599338 | Steel | Electrogalvanized | 160 mm | | M8 |
| UB4N168M8S6 | 599352 | Stainless Steel 316 (EN 1.4401) | | 168 mm | 150 | M8 |
| UB4N172M16EG | 599460 | Steel | Electrogalvanized | 172 mm | 150 | M16 |
| UB4N168M14 | 599240 | Steel | Electrogalvanized | 168 mm | 150 | M14 |
| UB4N172M16S6 | 599550 | Stainless Steel 316 (EN 1.4401) | | 172 mm | 150 | M16 |
| UB4N224M16EG | 599470 | Steel | Electrogalvanized | 224 mm | 200 | M16 |

| Catalog Number | Article Number | Material | Finish | Outer Diameter (OD) | NB/DN | Rod Size (RS) |
|------------------|----------------|---------------------------------------|--------|---------------------|-------|---------------|
| UB4N219M10S 6 | 599354 | Stainless Steel 316 (EN 1.4401) | | 219 mm | 200 | M10 |

Table 3/3

| Catalog Number | Article Number | Material | Finish | Outer Diameter (OD) | NB/DN | Rod Size (RS) |
|------------------|----------------|---------------------------------------|-------------------|---------------------|-------|---------------|
| UB4N224M12S 6 | 599555 | Stainless Steel 316 (EN 1.4401) | | 224 mm | 200 | M12 |
| UB4N219M16 | 599250 | Steel | Electrogalvanized | 219 mm | 200 | M16 |
| UB4N278M16E G | 599475 | Steel | Electrogalvanized | 278 mm | 250 | M16 |
| UB4N278M16S 6 | 599560 | Stainless Steel 316 (EN 1.4401) | | 278 mm | 250 | M16 |
| UB4N273M16 | 599260 | Steel | Electrogalvanized | 273 mm | 250 | M16 |
| UB4N323M10 | 599343 | Steel | Electrogalvanized | 323 mm | 300 | M10 |
| UB4N329M16S 6 | 599565 | Stainless Steel 316 (EN 1.4401) | | 345 mm | 300 | M16 |
| UB4N329M16E G | 599480 | Steel | Electrogalvanized | 345 mm | 300 | M16 |

Table 1/3

| Catalog Number | Article Number | Height (H) |
|----------------|----------------|------------|
| UB4N23M6S6 | 599485 | 50 mm |
| UB4N30M6EG | 599405 | 60 mm |
| UB4N027M8S6 | 597615 | 58 mm |
| UB4N30M6S6 | 599490 | 60 mm |
| UB4N36M8S6 | 599495 | 70 mm |
| UB4N36M8EG | 599410 | 70 mm |
| UB4N46M6EG | 599415 | 80 mm |
| UB4N042M8 | 599150 | 76 mm |
| UB4N46M6S6 | 599510 | 80 mm |
| UB4N049M8S6 | 597645 | 78 mm |

| Catalog Number | Article Number | Height (H) |
|----------------|----------------|------------|
| UB4N049M8 | 599160 | 78 mm |
| UB4N52M8S6 | 599515 | 90 mm |
| UB4N52M8EG | 599420 | 90 mm |
| UB4N042M8S6 | 597635 | 76 mm |
| UB4N64M8EG | 599425 | 100 mm |
| UB4N64M8S6 | 599520 | 100 mm |
| UB4N74M8EG | 599430 | 120 mm |
| UB4N74M8S6 | 599525 | 120 mm |
| UB4N076M8S6 | 597665 | 118 mm |
| UB4N94M10EG | 599440 | 140 mm |

Table 2/3

| Catalog Number | Article Number | Height (H) |
|----------------|----------------|------------|
| UB4N090M10 | 599190 | 125 mm |
| UB4N94M10S6 | 599530 | 140 mm |
| UB4N118M10EG | 599445 | 140 mm |
| UB4N118M10S6 | 599535 | 165 mm |
| UB4N114M10 | 599200 | 166 mm |
| UB4N114M8S6 | 599348 | 166 mm |
| UB4N146M12S6 | 599540 | 200 mm |
| UB4N146M12EG | 599450 | 200 mm |
| UB4N140M8S6 | 599350 | 197 mm |
| UB4N140M8 | 599337 | 197 mm |
| UB4N168M12EG | 599455 | 220 mm |
| UB4N168M12S6 | 599545 | 220 mm |
| UB4N160M8S6 | 599351 | 214 mm |
| UB4N160M8 | 599338 | 214 mm |
| UB4N168M8S6 | 599352 | 224 mm |
| UB4N172M16EG | 599460 | 240 mm |
| UB4N168M14 | 599240 | 224 mm |
| UB4N172M16S6 | 599550 | 240 mm |
| UB4N224M16EG | 599470 | 295 mm |
| UB4N219M10S6 | 599354 | 286 mm |

Table 3/3

| Catalog Number | Article Number | Height (H) |
|----------------|----------------|------------|
|----------------|----------------|------------|

| | | |
|--------------|--------|--------|
| UB4N224M12S6 | 599555 | 295 mm |
| UB4N219M16 | 599250 | 286 mm |
| UB4N278M16EG | 599475 | 350 mm |
| UB4N278M16S6 | 599560 | 350 mm |
| UB4N273M16 | 599260 | 331 mm |
| UB4N323M10 | 599343 | 389 mm |
| UB4N329M16S6 | 599565 | 400 mm |
| UB4N329M16EG | 599480 | 400 mm |

DIAGRAMS

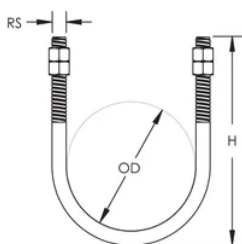

WARNING

nVent products shall be installed and used only as indicated in nVent's product instruction sheets and training materials. Instruction sheets are available at www.nvent.com and from your nVent customer service representative. Improper installation, misuse, misapplication or other failure to completely follow nVent's instructions and warnings may cause product malfunction, property damage, serious bodily injury and death and/or void your warranty.

North America

+1.800.753.9221
Option 1 – Customer Care
Option 2 – Technical
Support

Europe

Netherlands:
+31 800-0200135
France:
+33 800 901 793

Europe

Germany:
800 1890272
Other Countries:
+31 13 5835404

APAC

Shanghai:
+ 86 21 2412 1618/19
Sydney:
+61 2 9751 8500



Our powerful portfolio of brands:

CADDY ERICO HOFFMAN ILSCO SCHROFF TRACHTE

