

# Universal Structural Bracket, Strut Brace



## CERTIFICATIONS



## FEATURES

Used for installations where strut brace is perpendicular to structure

One wrench size fits all required hardware, eliminating the need to change tools

Shear-off head helps ensure correct torque and simplifies inspection

## SPECIFICATIONS

**Finish:** Electrogalvanized

**Material:** Steel

Table 1/2

Catalog Number	Article Number	Hole Size (HS)	Width (W)	Thickness (T)	A	B
CSBUS1	404568	14.3 mm	40.6 mm	6.4 mm	133.4 mm	12.7 mm
CSBUS2	404569	20.6 mm	40.6 mm	6.4 mm	133.4 mm	12.7 mm

Table 2/2

Catalog Number	Article Number	C	D	E
CSBUS1	404568	40.6 mm	50.8 mm	66 mm

Catalog Number	Article Number	C	D	E
CSBUS2	404569	40.6 mm	50.8 mm	66 mm

## ADDITIONAL PRODUCT DETAILS

Cut length for strut member is +/- 1" (25 mm) of measured length.

FM Loads					
Part Number	Brace Member	Horizontal Capacity per Installation Angle from Vertical			
		30° - 44°	45° - 59°	60° - 74°	75° - 90°
CSBUS1	41 x 41 Strut Channel	8940 N	12630 N	15210 N	16940 N
CSBUS2	41 x 41 Strut Channel	8940 N	12630 N	15210 N	16940 N

## DIAGRAMS

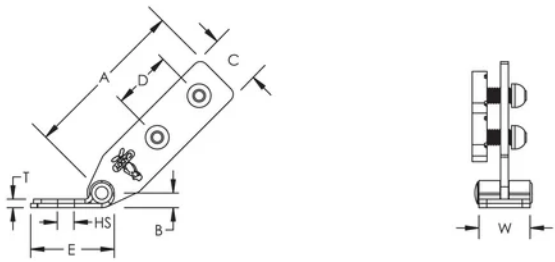

## WARNING

nVent products shall be installed and used only as indicated in nVent's product instruction sheets and training materials. Instruction sheets are available at [www.nvent.com](http://www.nvent.com) and from your nVent customer service representative. Improper installation, misuse, misapplication or other failure to completely follow nVent's instructions and warnings may cause product malfunction, property damage, serious bodily injury and death and/or void your warranty.

**North America**

+1.800.753.9221

Option 1 – Customer Care

Option 2 – Technical

Support

**Europe**

Netherlands:

+31 800-0200135

France:

+33 800 901 793

**Europe**

Germany:

800 1890272

Other Countries:

+31 13 5835404

**APAC**

Shanghai:

+ 86 21 2412 1618/19

Sydney:

+61 2 9751 8500



Our powerful portfolio of brands:

**CADDY ERICO HOFFMAN ILSCO SCHROFF TRACHTE**

