

Compression Straight Lug

Data Solutions



FEATURES

Tin plated for corrosion prevention

Annealed copper eases the crimping operation

Optimized sizes to the most efficient electrical conductivity

Best mechanical behavior (vibration/pull-out); DIN EN 61373 Class 1B "Railway Applications"

Markings on barrel for crimping

Consistent material thickness, precise diameter and accurate cable fit; DIN46235

SPECIFICATIONS

Material: Copper

Finish: Tinned

Table 1/2

| Catalog Number | Article Number | Lug/Connector Type | Conductor Size | Hole Size (HS) | Length (L) | Width (W) |
|----------------|----------------|------------------------|---|----------------|------------|-----------|
| PKS5010H | 715113 | Heavy-Duty DIN46235 | 1/0 Stranded, 50 mm ² Stranded | 10.5mm | 65mm | 21mm |
| PKS1610H | | Heavy-Duty DIN46235 | #6 Stranded, 16 mm ² Stranded | 10.5mm | 48mm | 17mm |

| Catalog Number | Article Number | Lug/Connector Type | Conductor Size | Hole Size (HS) | Length (L) | Width (W) |
|----------------|----------------|---------------------|--|----------------|------------|-----------|
| RKS2512T | 716653 | Standard | #3 Stranded, 25 mm ² Stranded | 13mm | 48mm | 19mm |
| PKS18512H | 715123 | Heavy-Duty DIN46235 | 185 mm ² Stranded, 350 kcmil Stranded | 13mm | 98mm | 37mm |
| RKS7012T | 716656 | Standard | 2/0 Stranded, 70 mm ² Stranded | 13mm | 59mm | 23mm |
| RKS12012H | 715121 | Standard | 120 mm ² Stranded, 250 kcmil Stranded | 13mm | 65mm | 28mm |
| PKS1612H | 715111 | Heavy-Duty DIN46235 | #5 Stranded, 16 mm ² Stranded | 13mm | 49mm | 18mm |
| RKS050019H | 716546 | Standard | 300 mm ² Stranded, 600 kcmil Stranded | 13mm | 109mm | 43mm |
| RKS24012H | 716544 | Standard | 240 mm ² Stranded, 500 kcmil Stranded | 13mm | 83mm | 39mm |
| RKS18512T | 716662 | Standard | 185 mm ² Stranded, 350 kcmil Stranded | 13mm | 83mm | 35mm |
| RKS15012T | 716660 | Standard | 150 mm ² Stranded, 300 kcmil Stranded | 13mm | 72mm | 31mm |
| RKS3512T | 716654 | Standard | #2 Stranded, 35 mm ² Stranded | 13mm | 51mm | 21mm |
| PKS24012H | 715127 | Heavy-Duty DIN46235 | 240 mm ² Stranded, 500 kcmil Stranded | 13mm | 108mm | 42mm |
| RKS1612T | 716652 | Standard | #5 Stranded, 16 mm ² Stranded | 13mm | 45mm | 19mm |
| RKS9512T | 716657 | Standard | 4/0 Stranded, 95 mm ² Stranded | 13mm | 62mm | 26mm |
| RKS612T | 716650 | Standard | 6 mm ² Stranded | 13mm | 41mm | 19mm |
| PKS24016H | 715128 | Heavy-Duty DIN46235 | 240 mm ² Stranded, 500 kcmil Stranded | 15mm | 111mm | 42mm |

| Catalog Number | Article Number | Lug/Connector Type | Conductor Size | Hole Size (HS) | Length (L) | Width (W) |
|----------------|----------------|------------------------|--|----------------|------------|-----------|
| PKS15016H | 715122 | Heavy-Duty DIN46235 | 150 mm ² Stranded, 300 kcmil Stranded | 15mm | 97mm | 34mm |
| PKS18516H | 715124 | Heavy-Duty DIN46235 | 185 mm ² Stranded, 350 kcmil Stranded | 15mm | 101mm | 37mm |
| PKS30020H | 715136 | Heavy-Duty DIN46235 | 300 mm ² Stranded, 600 kcmil Stranded | 15mm | 119mm | 46mm |

Table 2/2

| Catalog Number | Article Number | Lug/Connector Type | Conductor Size | Hole Size (HS) | Length (L) | Width (W) |
|----------------|----------------|------------------------|--|----------------|------------|-----------|
| PKS12014H | 715116 | Heavy-Duty DIN46235 | 120 mm ² Stranded, 250 kcmil Stranded | 15mm | 88mm | 32mm |
| PKS40020H | 715138 | Heavy-Duty DIN46235 | 400 mm ² Stranded, 800 kcmil Stranded | 15mm | 140mm | 54mm |
| PKS30016H | 715129 | Heavy-Duty DIN46235 | 300 mm ² Stranded, 600 kcmil Stranded | 17mm | 119mm | 46mm |
| PKS40016H | 715137 | Heavy-Duty DIN46235 | 400 mm ² Stranded, 800 kcmil Stranded | 17mm | 140mm | 54mm |
| RKS15016T | 716661 | Standard | 150 mm ² Stranded, 300 kcmil Stranded | 17mm | 72mm | 31mm |
| RKS9516T | 716658 | Standard | 4/0 Stranded, 95 mm ² Stranded | 17mm | 66mm | 26mm |
| RKS24016T | 716664 | Standard | 240 mm ² Stranded, 500 kcmil Stranded | 17mm | 93mm | 39mm |
| RKS18516T | 716663 | Standard | 185 mm ² Stranded, 350 kcmil Stranded | 17mm | 83mm | 35mm |
| RKS40016T | 716666 | Standard | 400 mm ² Stranded, 800 kcmil Stranded | 17mm | 114mm | 49mm |
| RKS12016T | 716659 | Standard | 120 mm ² Stranded, 250 kcmil Stranded | 17mm | 67mm | 28mm |

| Catalog Number | Article Number | Lug/Connector Type | Conductor Size | Hole Size (HS) | Length (L) | Width (W) |
|----------------|----------------|--------------------|--|----------------|------------|-----------|
| RKS30016T | 716665 | Standard | 300 mm ² Stranded, 600 kcmil Stranded | 17mm | 101mm | 43mm |

Table 1/2

| Catalog Number | Article Number | Tool/Die Type |
|----------------|----------------|--|
| PKS5010H | 715113 | M2M or M2H/PKM2, M3H or M3B/PKM3, MLB/PKML |
| PKS1610H | | M2M or M2H/RKM2, M3H or M3B/RKM3, MLB/RKML |
| RKS2512T | 716653 | M2M or M2H/RKM2, M3H or M3B/RKM3, MLB/RKML |
| PKS18512H | 715123 | M2M or M2H/PKM2, M3H or M3B/PKM3, MLB/PKML |
| RKS7012T | 716656 | M2M or M2H/RKM2, M3H or M3B/RKM3, MLB/RKML |
| RKS12012H | 715121 | M2M or M2H/RKM2, M3H or M3B/RKM3, MLB/RKML |
| PKS1612H | 715111 | M2M or M2H/PKM2, M3H or M3B/PKM3, MLB/PKML |
| RKS050019H | 716546 | M2M or M2H/RKM2, M3H or M3B/RKM3 |
| RKS24012H | 716544 | M2M or M2H/RKM2, M3H or M3B/RKM3, MLB/RKML |
| RKS18512T | 716662 | M2M or M2H/RKM2, M3H or M3B/RKM3, MLB/RKML |
| RKS15012T | 716660 | M2M or M2H/RKM2, M3H or M3B/RKM3, MLB/RKML |
| RKS3512T | 716654 | M2M or M2H/RKM2, M3H or M3B/RKM3, MLB/RKML |
| PKS24012H | 715127 | M2M or M2H/PKM2, M3H or M3B/PKM3 |
| RKS1612T | 716652 | M2M or M2H/RKM2, M3H or M3B/RKM3, MLB/RKML |
| RKS9512T | 716657 | M2M or M2H/RKM2, M3H or M3B/RKM3, MLB/RKML |
| RKS612T | 716650 | M2M or M2H/RKM2, MLB/RKML |
| PKS24016H | 715128 | M2M or M2H/PKM2, M3H or M3B/PKM3 |

| Catalog Number | Article Number | Tool/Die Type |
|----------------|----------------|--|
| PKS15016H | 715122 | M2M or M2H/PKM2, M3H or M3B/PKM3, MLB/PKML |
| PKS18516H | 715124 | M2M or M2H/PKM2, M3H or M3B/PKM3, MLB/PKML |
| PKS30020H | 715136 | M2M or M2H/PKM2, M3H or M3B/PKM3 |

Table 2/2

| Catalog Number | Article Number | Tool/Die Type |
|----------------|----------------|--|
| PKS12014H | 715116 | M2M or M2H/PKM2, M3H or M3B/PKM3, MLB/PKML |
| PKS40020H | 715138 | M4FP/PKM4, MLB |
| PKS30016H | 715129 | M2M or M2H/PKM2, M3H or M3B/PKM3 |
| PKS40016H | 715137 | M4FP/PKM4 |
| RKS15016T | 716661 | M2M or M2H/RKM2, M3H or M3B/RKM3, MLB/RKML |
| RKS9516T | 716658 | M2M or M2H/RKM2, M3H or M3B/RKM3, MLB/RKML |
| RKS24016T | 716664 | M2M or M2H/RKM2, M3H or M3B/RKM3, MLB/RKML |
| RKS18516T | 716663 | M2M or M2H/RKM2, M3H or M3B/RKM3, MLB/RKML |
| RKS40016T | 716666 | M3H or M3B/RKM3 |
| RKS12016T | 716659 | M2M or M2H/RKM2, M3H or M3B/RKM3, MLB/RKML |
| RKS30016T | 716665 | M2M or M2H/RKM2, M3H or M3B/RKM3 |

DIAGRAMS

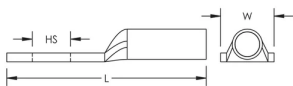

WARNING

nVent products shall be installed and used only as indicated in nVent's product instruction sheets and training materials. Instruction sheets are available at www.nvent.com and from your nVent customer service representative. Improper installation, misuse, misapplication or other failure to completely follow nVent's instructions and warnings may cause product malfunction, property damage, serious bodily injury and death and/or void your warranty.



Our powerful portfolio of brands:

CADDY ERICO HOFFMAN ILSCO SCHROFF TRACHTE