

Compression Straight Lug

Data Solutions



FEATURES

Tin plated for corrosion prevention

Annealed copper eases the crimping operation

Optimized sizes to the most efficient electrical conductivity

Best mechanical behavior (vibration/pull-out); DIN EN 61373 Class 1B "Railway Applications"

Markings on barrel for crimping

Consistent material thickness, precise diameter and accurate cable fit; DIN46235

SPECIFICATIONS

Material: Copper

Finish: Tinned

Table 1/2

Catalog Number	Lug/Connector Type	Conductor Size	Hole Size (HS)	Length (L)	Width (W)	Tool/Die Type
PKS5010H	Heavy-Duty DIN46235	1/0 Stranded, 50 mm ² Stranded	0.41 in	2.6 in	0.8 in	M2M or M2H/PKM2, M3H or M3B/PKM3, MLB/PKML

Catalog Number	Lug/Connector Type	Conductor Size	Hole Size (HS)	Length (L)	Width (W)	Tool/Die Type
RKS1612T	Standard	#5 Stranded, 16 mm ² Stranded	0.51in	1.8in	0.75in	M2M or M2H/RKM2, M3H or M3B/RKM3, MLB/RKML
RKS612T	Standard	6 mm ² Stranded	0.51in	1.6in	0.75in	M2M or M2H/RKM2, MLB/RKML
PKS18512H	Heavy-Duty DIN46235	185 mm ² Stranded, 350 kcmil Stranded	0.51in	3.9in	1.5in	M2M or M2H/PKM2, M3H or M3B/PKM3, MLB/PKML
RKS24012H	Standard	240 mm ² Stranded, 500 kcmil Stranded	0.51in	3.3in	1.5in	M2M or M2H/RKM2, M3H or M3B/RKM3, MLB/RKML
RKS15012T	Standard	150 mm ² Stranded, 300 kcmil Stranded	0.51in	2.8in	1.2in	M2M or M2H/RKM2, M3H or M3B/RKM3, MLB/RKML
RKS7012T	Standard	2/0 Stranded, 70 mm ² Stranded	0.51in	2.3in	0.9in	M2M or M2H/RKM2, M3H or M3B/RKM3, MLB/RKML
RKS050019H	Standard	300 mm ² Stranded, 600 kcmil Stranded	0.51in	4.3in	1.7in	M2M or M2H/RKM2, M3H or M3B/RKM3
RKS9512T	Standard	4/0 Stranded, 95 mm ² Stranded	0.51in	2.4in	1in	M2M or M2H/RKM2, M3H or M3B/RKM3, MLB/RKML
RKS12012H	Standard	120 mm ² Stranded, 250 kcmil Stranded	0.51in	2.6in	1.1in	M2M or M2H/RKM2, M3H or M3B/RKM3, MLB/RKML

Catalog Number	Lug/Connector Type	Conductor Size	Hole Size (HS)	Length (L)	Width (W)	Tool/Die Type
PKS1612H	Heavy-Duty DIN46235	#5 Stranded, 16 mm ² Stranded	0.51in	1.9in	0.7in	M2M or M2H/PKM2, M3H or M3B/PKM3, MLB/PKML
RKS2512T	Standard	#3 Stranded, 25 mm ² Stranded	0.51in	1.9in	0.75in	M2M or M2H/RKM2, M3H or M3B/RKM3, MLB/RKML
PKS24012H	Heavy-Duty DIN46235	240 mm ² Stranded, 500 kcmil Stranded	0.51in	4.3in	1.7in	M2M or M2H/PKM2, M3H or M3B/PKM3
RKS18512T	Standard	185 mm ² Stranded, 350 kcmil Stranded	0.51in	3.3in	1.4in	M2M or M2H/RKM2, M3H or M3B/RKM3, MLB/RKML
RKS3512T	Standard	#2 Stranded, 35 mm ² Stranded	0.51in	2in	0.8in	M2M or M2H/RKM2, M3H or M3B/RKM3, MLB/RKML
PKS24016H	Heavy-Duty DIN46235	240 mm ² Stranded, 500 kcmil Stranded	0.59in	4.4in	1.7in	M2M or M2H/PKM2, M3H or M3B/PKM3
PKS15016H	Heavy-Duty DIN46235	150 mm ² Stranded, 300 kcmil Stranded	0.59in	3.8in	1.3in	M2M or M2H/PKM2, M3H or M3B/PKM3, MLB/PKML
PKS40020H	Heavy-Duty DIN46235	400 mm ² Stranded, 800 kcmil Stranded	0.59in	5.5in	2.1in	M4FP/PKM4, MLB
PKS18516H	Heavy-Duty DIN46235	185 mm ² Stranded, 350 kcmil Stranded	0.59in	4in	1.5in	M2M or M2H/PKM2, M3H or M3B/PKM3, MLB/PKML
PKS30020H	Heavy-Duty DIN46235	300 mm ² Stranded, 600 kcmil Stranded	0.59in	4.7in	1.8in	M2M or M2H/PKM2, M3H or M3B/PKM3

Table 2/2

Catalog Number	Lug/Connector Type	Conductor Size	Hole Size (HS)	Length (L)	Width (W)	Tool/Die Type
PKS12014H	Heavy-Duty DIN46235	120 mm ² Stranded, 250 kcmil Stranded	0.59in	3.5in	1.3in	M2M or M2H/PKM2, M3H or M3B/PKM3, MLB/PKML
RKS30016T	Standard	300 mm ² Stranded, 600 kcmil Stranded	0.67in	4in	1.7in	M2M or M2H/RKM2, M3H or M3B/RKM3
RKS24016T	Standard	240 mm ² Stranded, 500 kcmil Stranded	0.67in	3.7in	1.5in	M2M or M2H/RKM2, M3H or M3B/RKM3, MLB/RKML
PKS40016H	Heavy-Duty DIN46235	400 mm ² Stranded, 800 kcmil Stranded	0.67in	5.5in	2.1in	M4FP/PKM4
RKS9516T	Standard	4/0 Stranded, 95 mm ² Stranded	0.67in	2.6in	1in	M2M or M2H/RKM2, M3H or M3B/RKM3, MLB/RKML
PKS30016H	Heavy-Duty DIN46235	300 mm ² Stranded, 600 kcmil Stranded	0.67in	4.7in	1.8in	M2M or M2H/PKM2, M3H or M3B/PKM3
RKS12016T	Standard	120 mm ² Stranded, 250 kcmil Stranded	0.67in	2.6in	1.1in	M2M or M2H/RKM2, M3H or M3B/RKM3, MLB/RKML
RKS40016T	Standard	400 mm ² Stranded, 800 kcmil Stranded	0.67in	4.5in	1.9in	M3H or M3B/RKM3
RKS15016T	Standard	150 mm ² Stranded, 300 kcmil Stranded	0.67in	2.8in	1.2in	M2M or M2H/RKM2, M3H or M3B/RKM3, MLB/RKML
RKS18516T	Standard	185 mm ² Stranded, 350 kcmil Stranded	0.67in	3.3in	1.4in	M2M or M2H/RKM2, M3H or M3B/RKM3, MLB/RKML

DIAGRAMS

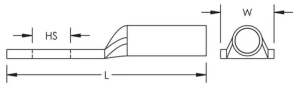

WARNING

nVent products shall be installed and used only as indicated in nVent's product instruction sheets and training materials. Instruction sheets are available at www.nvent.com and from your nVent customer service representative. Improper installation, misuse, misapplication or other failure to completely follow nVent's instructions and warnings may cause product malfunction, property damage, serious bodily injury and death and/or void your warranty.



Our powerful portfolio of brands:

CADDY ERICO HOFFMAN ILSCO SCHROFF TRACHTE